

LAYOUT PLAN OF INDUSTRIAL AREA OF SANDILA PHASE-II

AMENDED DATE ON 03-09-2019 (ONLY FOR REFERENCE)

DISCLAIMER:-

THIS MAP IS PROVIDED FOR INFORMATION PURPOSE ONLY AND IS NOT INTENDED FOR USE IN LEGAL PROCEEDINGS. THE ACCURACY AND COMPLETENESS OF THE INFORMATION REPRESENTED ARE NOT GUARANTEED. THE INFORMATION PRESENTED HEREIN, INCLUDING BOUNDARIES, LAND USE DESIGNATIONS, AND OTHER DETAILS, IS SUBJECT TO CHANGE WITHOUT PRIOR NOTICE. THE MAP SHOULD NOT BE USED AS A LEGAL DOCUMENT OR FOR ANY PURPOSE REQUIRING PRECISE MEASUREMENTS OR LEGAL VALIDATION. FOR OFFICIAL AND LEGALLY BINDING INFORMATION PLEASE CONSULT RELEVANT OFFICE AUTHORITY.

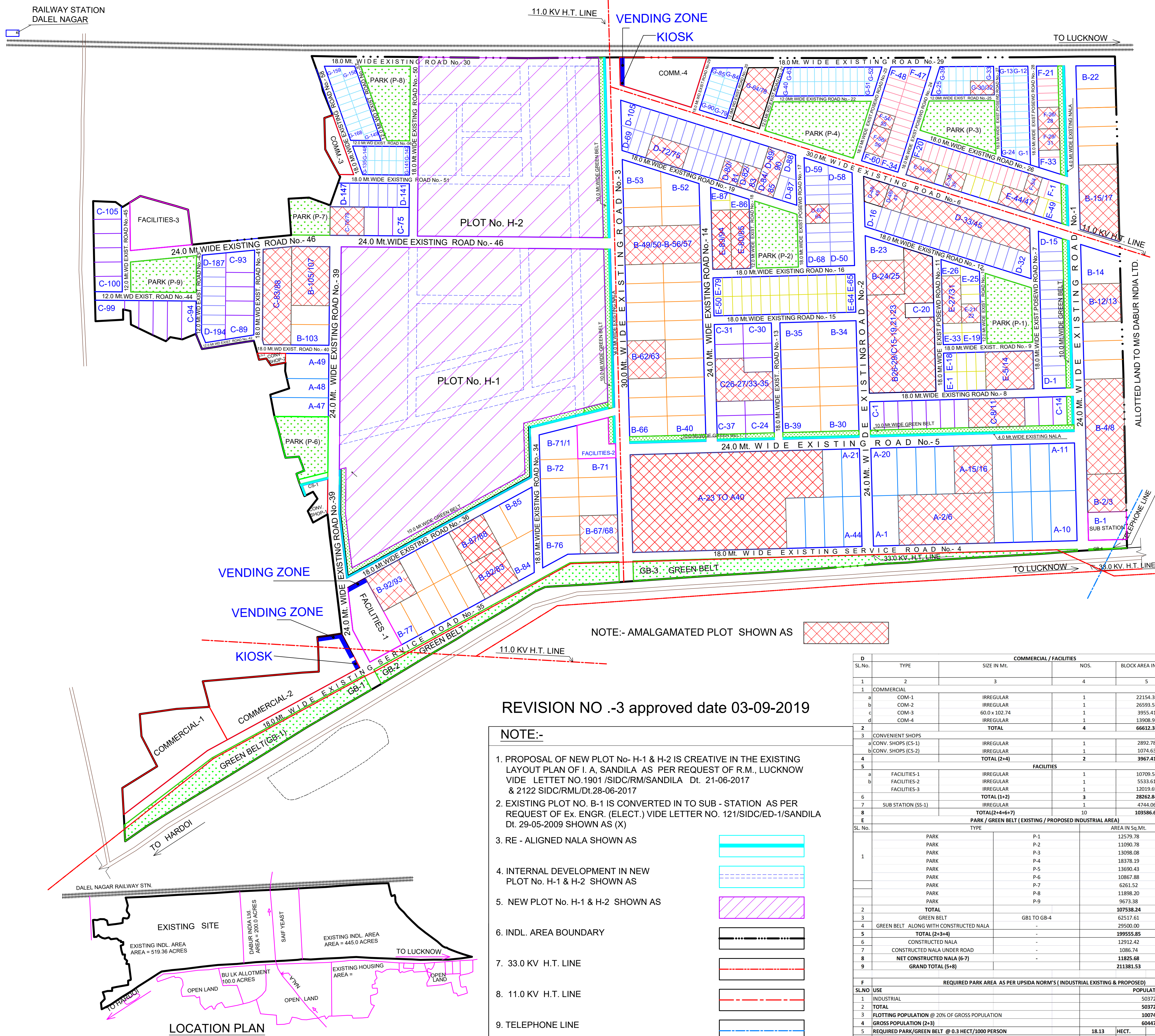

SL. No.	AREA STATEMENT	AREA IN Sq.Mt.	AREA IN ACRES
1	TOTAL LAND AREA AS PER PREVIOUS APPROVED LAYOUT PLAN ON Dt. 30-08-2006	2101775.35	519.360
2	TOTAL LAND AREA AS PER AUTO CAD CALCULATION	2093762.07	517.380
3	DEVIATION (1-2)	8013.28	1.980

SL. NO.	LAND USE	AREA IN SQ.MT.	AREA IN ACRES	% OF TOTAL
1	INDUSTRIAL PLOTS	1418427.11	350.35	67.75
2	FACILITIES	28262.84	6.98	1.35
3	SUB-STATION	4744.06	1.17	0.23
4	COMMERCIAL	66612.34	16.45	3.18
5	SHOPS	3967.41	0.98	0.19
6	CONSTRUCTED NALA	11825.68	2.92	0.56
7	GREEN BELT ALONG WITH NALA	29500.00	7.29	1.41
8	GREEN BELT	62517.61	15.44	2.99
9	PARK	107538.24	26.56	5.14
10	ROADS	360366.78	89.23	17.21
11	GRAND TOTAL	2093762.07	517.380	100.00

SL. No.	TYPE	SIZE IN MT.	AREA IN Sq.Mt.	PLOT NOS.	BLOCK AREA IN Sq.Mt.	BLOCK AREA IN ACRES	L.W.F./1000	POPULATION
1	A-1 TO A-44	40.00 x 100.00	4000.00	44	187056.49	46.22	40	7482
2	A-47 TO A-49	IRREGULAR	3852.26 TO 4770.24	3	13315.66	3.29	40	533
3	B-2 TO B-71/1	40.00 x 80.00	3200.00	71	246526.10	60.92	40	9861
4	B-72 TO B-93	40.00 x 80.00	3934.62 TO 4607.84	22	74018.76	18.29	40	2961
5	B-103 TO B-107	40.00 x 80.00	3200.00	107	16574.67	4.10	40	663
6	C-1 TO C-53	30.0 x 60.0	1800.00	53	105754.30	26.13	40	4230
7	C-75 TO C-79	30.0 x 60.0	1800.00	5	10382.01	2.57	40	415
8	C-83 TO C-93	30.0 x 60.0	1800.00	11	23020.35	5.69	40	921
9	C-94 TO C-99	IRREGULAR	1197.0 TO 235.24	6	12650.17	3.14	40	508
10	C-100 TO C-105	30.0 x 60.0	1800.00	6	11054.16	2.73	40	442
11	D-1 TO D-105	20.0 x 50.0	1000.00	105	112431.52	27.78	50	5622
12	D-141 TO D-147	20.0 x 50.0	1000.00	7	7496.74	1.85	50	375
13	D-187 TO D-194	20.0 x 50.0	1000.00	8	9091.79	2.25	50	455
14	E-1 TO E-94	20.0 x 40.0	800.00	94	78290.25	19.35	50	3915
15	F-1 TO F-60	15.0 x 40.0	600.00	60	40391.77	9.98	50	2020
16	G-1 TO G-99	15.0 x 40.0	450.00	99	52679.66	13.02	60	3161
17	G-135 TO G-168	15.0 x 40.0	450.00	34	52679.66	13.02	60	3161
18	H-1	TO SIZE	220317.76	1	220317.76	54.44	10	2203
19	H-2	TO SIZE	144655.29	1	144655.29	35.74	10	1447
	TOTAL		144655.29	728	1418427.11	350.49		50372

REVISION NO. -3 approved date 03-09-2019

- NOTE:-**
- PROPOSAL OF NEW PLOT No- H-1 & H-2 IS CREATIVE IN THE EXISTING LAYOUT PLAN OF I. A. SANDILA AS PER REQUEST OF R.M., LUCKNOW VIDE LETTET NO.1901/SIDC/RM/SANDILA Dt. 21-06-2017 & 2122 SIDC/RM/Dt.28-06-2017
 - EXISTING PLOT No. B-1 IS CONVERTED IN TO SUB - STATION AS PER REQUEST OF Ex. ENGR. (ELECT.) VIDE LETTER NO. 121/SIDC/ED-1/SANDILA Dt. 29-05-2009 SHOWN AS (X)
 - RE - ALIGNED NALA SHOWN AS
 - INTERNAL DEVELOPMENT IN NEW PLOT No. H-1 & H-2 SHOWN AS
 - NEW PLOT No. H-1 & H-2 SHOWN AS
 - INDL. AREA BOUNDARY
 - 33.0 KV H.T. LINE
 - 11.0 KV H.T. LINE
 - TELEPHONE LINE

SL. No.	TYPE	SIZE IN MT.	NOS.	BLOCK AREA IN Sq.Mt.	BLOCK AREA IN ACRES
1	COMMERCIAL				
a	COM-1	IRREGULAR	1	22154.39	5.47
b	COM-2	IRREGULAR	1	26593.57	6.57
c	COM-3	60.0 x 102.74	1	3955.41	0.98
d	COM-4	IRREGULAR	1	13908.97	3.44
	TOTAL		4	66612.34	16.46
2	CONVENIENT SHOPS				
a	CONV. SHOPS (CS-1)	IRREGULAR	1	2892.78	0.71
b	CONV. SHOPS (CS-2)	IRREGULAR	1	1074.63	0.27
	TOTAL (2+4)		2	3967.41	0.98
3	FACILITIES				
a	FACILITIES-1	IRREGULAR	1	10709.54	2.65
b	FACILITIES-2	IRREGULAR	1	5533.61	1.37
c	FACILITIES-3	IRREGULAR	1	12019.69	2.97
	TOTAL (1+2)		3	28262.84	6.98
6	SUB STATION (SS-1)	IRREGULAR	1	4744.06	1.17
	TOTAL(2+4+6+7)		10	103586.65	25.60
E	PARK / GREEN BELT (EXISTING / PROPOSED INDUSTRIAL AREA)				
1	PARK	P-1	1	12579.78	3.11
	PARK	P-2	1	11090.78	2.74
	PARK	P-3	1	13098.08	3.24
	PARK	P-4	1	18378.19	4.54
	PARK	P-5	1	13690.43	3.38
	PARK	P-6	1	10867.88	2.69
	PARK	P-7	1	6261.52	1.55
	PARK	P-8	1	11898.20	2.94
	PARK	P-9	1	9673.38	2.39
	TOTAL		9	107538.24	26.57
3	GREEN BELT	GB1 TO GB-4	1	62517.61	15.45
4	GREEN BELT ALONG WITH CONSTRUCTED NALA		1	29500.00	7.29
	TOTAL (2+3+4)		3	199555.85	49.31
6	CONSTRUCTED NALA		1	12912.42	3.19
7	CONSTRUCTED NALA UNDER ROAD		1	1086.74	0.27
8	NET CONSTRUCTED NALA (6-7)		1	11825.68	2.92
9	GRAND TOTAL (5+8)		1	211381.53	52.23
F	REQUIRED PARK AREA AS PER UPSIDA NORM'S (INDUSTRIAL EXISTING & PROPOSED)				
1	INDUSTRIAL				50372
2	TOTAL				50372
3	FLOTTING POPULATION @ 20% OF GROSS POPULATION				10074
4	GROSS POPULATION (2+3)				60447
5	REQUIRED PARK/GREEN BELT @ 0.3 HECT/1000 PERSON	18.13	HECT.	44.81	ACRES
6	REQUIRED PARK/GREEN BELT AREA AS PER APPROVED LAYOUT PLAN Dt. 30-08-2006	21.08	HECT.	52.08	ACRES
7	PROPOSED PARK/GREEN BELT	21.14	HECT.	52.23	ACRES

ARCHITECTURAL CELL



UPSIDA COMPLEX
A 1/4 LAKHANPUR KANPUR.

JOB TITLE :-
LAYOUT PLAN OF INDL. AREA SANDILA Distt. HARDOI (UP)
PHASE - II

DRG. TITLE :-
CREATION OF INDL. PLOT H-1 & H-2

APPROVED ON. - Dt. 30-08-2006
REVISION NO.-1 Dt. 03-06-2009
REVISION NO. -2 approved date 27-10-2017

SCALE :- 1Cm. = 30.0 Mt.

DRG. NO. :-

DATE :- 21-07-2017

DEALT BY:- AMIT SRIVASTAVA (D/MAN)